

# Leverage FX3-LX for promotional activities to attract, retain and grow customers

## Promotion with small games / coupons



To promote repeat visit, offer customer opportunity to win free refill coupon acceptable at other outlets by playing coupon roulette displayed on FX3-LX.



**FX3-LX**

## Self-ordering

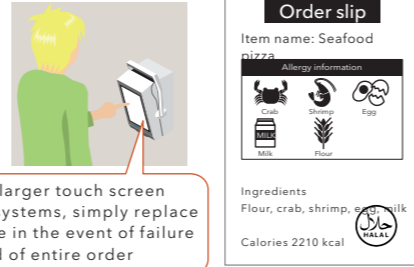

Unlike larger touch screen order systems, simply replace console in the event of failure instead of entire order

With its multi-language capability, customer can easily place order and pass order slip to staff for processing. By speeding up ordering process with greater accuracy, customer waiting time is shortened and experience is improved.

## Personalisation



Customer can write personal messages which can be printed as is to be applied on products. Label can also include QR code to lead customer to promotional website.

## Fun for kids



Print photo with small-sized camera connected to FX3-LX. Print labels with different designs based on weather or time for example. Combine several labels to form a complete picture. Great promotion for families with kids.

## Print food preference card



1. Generate QR code to show your food preference (for e.g. "no onion").
2. Scan QR code with reader in the store, issue order slip and pass it to store staff.

- Easy to order when customer revisits with food preference card
- Easy for customers to order on behalf of others if visiting in groups
- Easy for non-native speakers who are not fluent in local language
- Easy to order for customers with hearing and/or speaking

## Reasons why FX3-LX is the best choice for restaurants

- ✓ Senior-friendly - Small letters showing ingredients and allergy information are clearly shown with high definition (305 dpi)
- ✓ Can be used for different labels with different label length depending the printed text (Linerless label)
- ✓ SATO AEP\*1 enables allergens to be shown in bold on label for customer reassurance
- ✓ Enables headquarter to capture data such as 'Which store', 'When' and 'How many labels printed'
- ✓ Update restaurant menus simultaneously in multiple locations (through SATO App Storage\*2)
- ✓ Provides visibility of printer operation status, enables asset management and update of system software simultaneously in multiple locations (through SATO Online Services\*3)

\*1 Application Enabled Printing platform allows device to be used as a PC-less, online standalone printer.  
 \*2 SATO App Storage is a cloud-based data management service to centrally manage and distribute data efficiently.  
 \*3 SATO Online Services is a cloud-based IoT solution to monitor printer operation status 24/7 for stable operation.

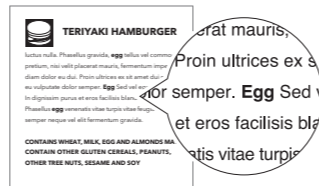
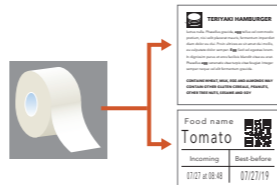

# Food Service Industry Solutions

## SATO Australia Pty Limited

Regional Headquarter - VIC  
 6 Federation Way, Chifley Business Park,  
 Mentone VIC 3194, Australia  
[www.sato-oceania.com](http://www.sato-oceania.com)

Satellite Sales Office - NSW  
 Level 1, Unit 17, 75 Corish Circle,  
 Banksmeadow NSW 2019 Sydney, Australia

## SATO New Zealand Limited

Regional Sales & Manufacturing  
 30 Apollo Drive, Mairangi Bay,  
 Auckland 0632, New Zealand



## Food shrinkage



- ! - Want to understand optimum inventory to minimise food shrinkage
- Want to improve productivity by cutting down manual inventory counting

### Print temperature / humidity logs for food transportation **HACCP**

Record temperature readings in refrigerator / freezer truck during transportation. Use a smartphone & mobile printer to print the temperature log and apply it on the product when receiving or upon delivery.



### For receiving, FIFO, inventory control

Connect with general-purpose scanner or weighing scale to support receiving, FIFO, inventory control.

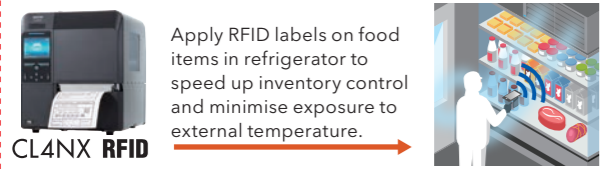
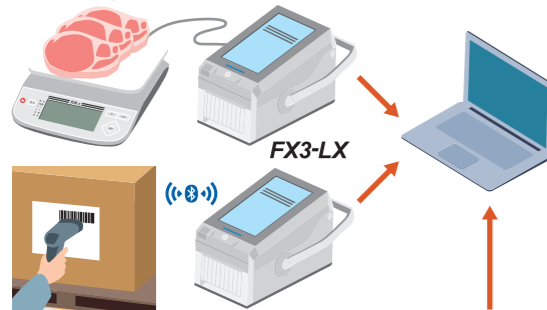

## Access control & security

- ! - Need to easily & flexibly issue entrance pass for hourly shift employee while ensuring security of premises

### Enhance security at entrance/exit at low cost using RFID

RFID entrance pass is a more affordable option than PVC IC card.

Simply tap pass on reader to record entrance and exit data. Add employee identification details (for e.g. employee ID number) for tracking to further enhance security.

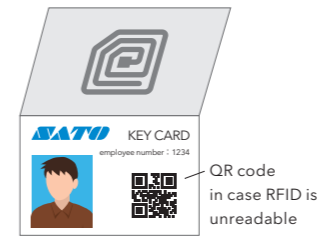

## Food management



- ! - Want to minimise training required to learn food menu
- Both skilled and newly hired employees need to easily issue 'use-by' label that is easy to understand

### FX3-LX enables accurate food expiry date management **HACCP**

Multiple ways to search for food name - By group, food name, product number, etc. Real-time clock provides accurate date-coding on labels to enhance food safety.



### Paperless recording of food core temperature **HACCP**

After measuring core temperature of food, enter data into FX3-LX for paperless data management.



Printer designed to address challenges faced by restaurants

## FX3-LX

## Delivery service / Drive-through / Takeaway

- ! Want to clearly display allergy information to show consumers

### Print food ingredients and allergy information on security label

FX3-LX can print product name, raw material, package date / time, allergy advice on non-reusable label.

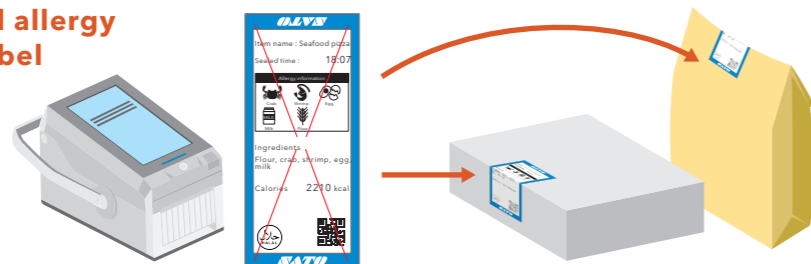

### Wall mountable



### Splash proof

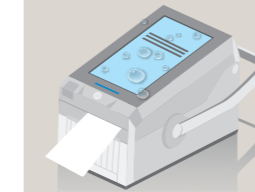

With IPx2 rating, FX3-LX printer can resist water splashes.

### Bug proof

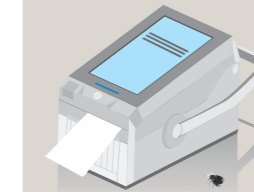

Bug proof mechanism makes it harder for insects to get in the printer thus minimising system failure caused by bugs.

### Easy operation when wearing rubber gloves



Pressure-sensitive touch screen can be operated even when wearing rubber gloves.

### Multiple-language instruction/printing



Different languages can be set for instruction display and label printing thus eliminating operational difficulty due to language barrier. For e.g. instruction can be displayed in Chinese while label is printed in English.

### Application can be customised to fit customer needs

